



18 Nash Close

, Lordswood, ME5 8QW

Offers Around £290,000



FANTASTIC PRICED PROPERTY**NO CHAIN**GARAGE**DRIVE**REAR GARDEN**TWO DOUBLE BEDROOMS**
OPEN DAY 26TH NOVEMBER 2022

This 2 double bedroom terrace house in Lordswood has just hit the sales market and is offered with no forward chain. The property benefits from new fencing, new cladding, new upstairs carpets and a replacement front door. Internal accommodation comprises entrance area, lounge, kitchen/breakfast room and a conservatory offering extra space downstairs. To the first floor there are two double bedrooms and a family bathroom. Further benefits include, gas central heating, double glazed windows, a rear garden, garage, a drive for 2 cars to the front for easy parking and NO CHAIN
Lordswood is a southern suburb of Chatham, Kent, located approximately 3 miles south of Chatham town centre. Lordswood possesses pockets of woodland, local shops and a health centre, with good access routes to the motorway. Call us now to book your slot to view. Council tax band B



- Entrance area
- lounge
- kitchen/diner
- conservatory
- stairs/landing
- bedroom 1
- bedroom 2
- bathroom
- garden
- garage
- parking

Area Map



Floor Plans

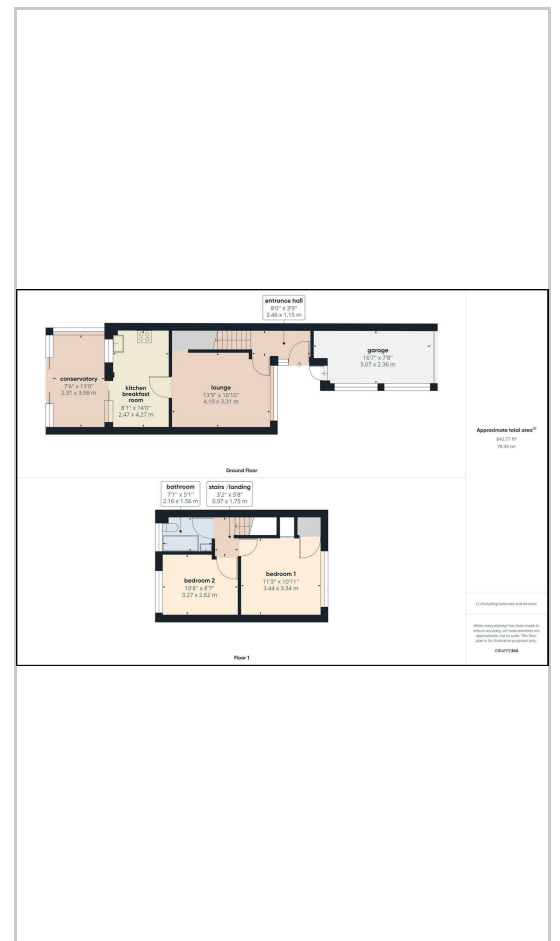

Energy Efficiency Graph

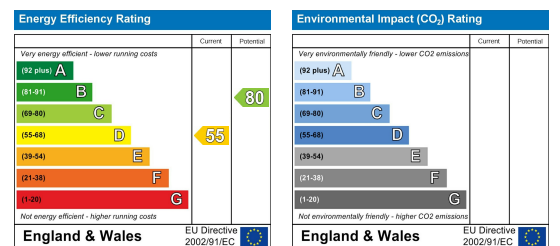

These particulars, whilst believed to be accurate are set out as a general outline only for guidance and do not constitute any part of an offer or contract. Intending purchasers should not rely on them as statements of representation of fact, but must satisfy themselves by inspection or otherwise as to their accuracy. No person in this firm's employment has the authority to make or give any representation or warranty in respect of the property.